

Impeller change procedure:

Remove security pin and steering shaft. Use pliers.



Unscrew 4 long screws, key 10 mm (lower plate is removed for better visibility)

Unplug rubber vacuum line.



Remove nozzle – just wiggle and pull.

Release rubber hose -cooling water supply

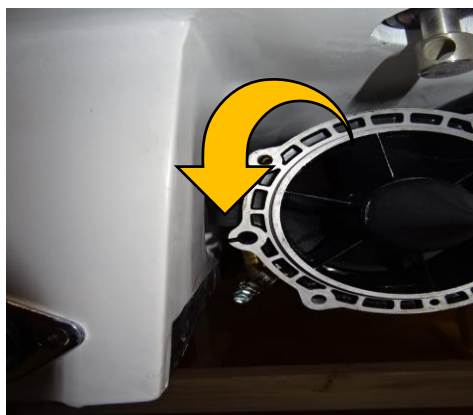

Remove jet pump stator – just wiggle and pull. Now stator is free.



Unscrew plastic cone. If you are strong, by hand or with some big pliers. Don't squeeze plastic cone.

Remove rubber seal.

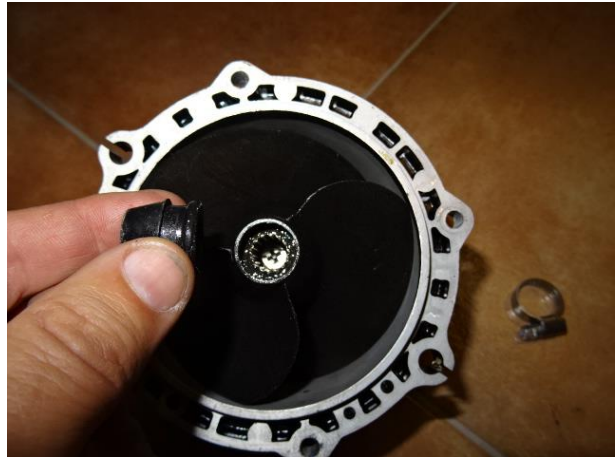

Unscrew – remove Philips (cross) screw.



Note brass security insert below Philips screw. Take one of the long screws you removed previously.



Screw long screw in the hole of brass security insert. Pull it out. Wiggle if needed.



Remove brass security insert. Prepare tool to hold shaft. Pliers will also be good for this purpose.



Hold shaft and in same time rotate (unscrew) impeller. **In direction of the arrow.**

Rotate impeler clockwise. This is oposite rotation than “normal “ screws

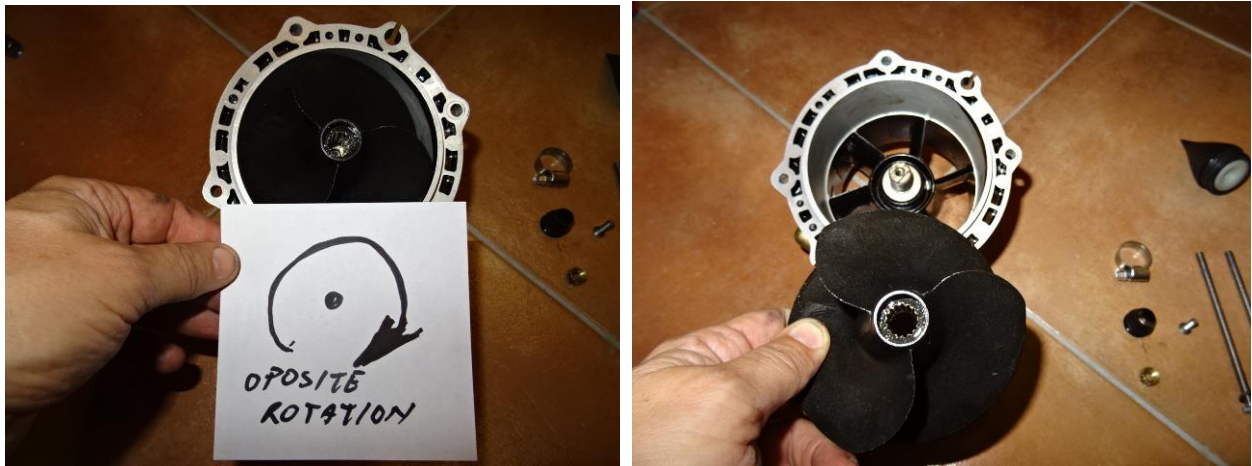

Security insert have function to prevent unscrewing of the impeller. **Note alignment.**

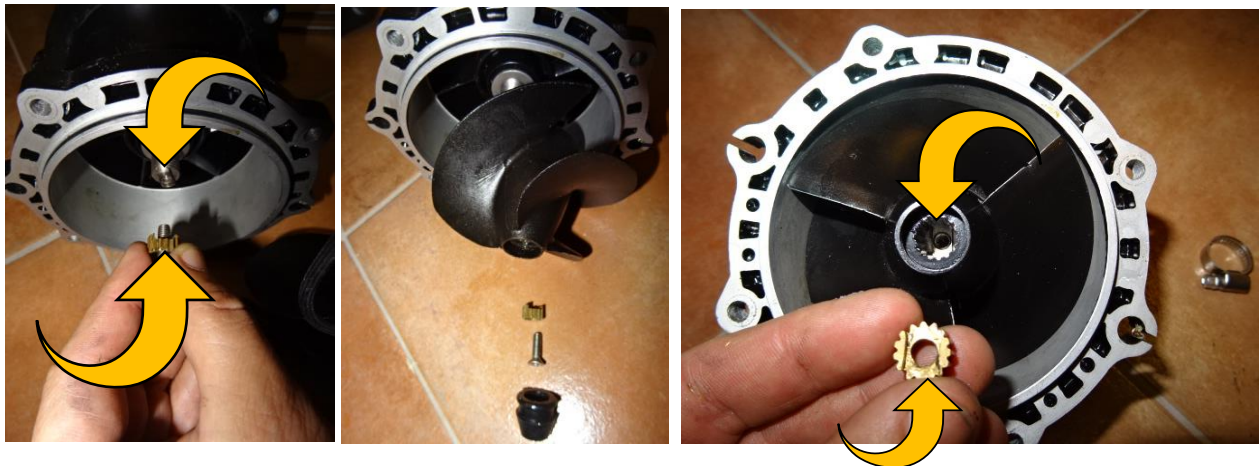

Security insert have function to prevent unscrewing of the impeller.

To place it back in position use same procedure (long screw). **Note alignment.**



Security insert is in positin. Tighten it with philips (cross) screw.



Assamble pump just folowing oposite procedure.

Tools I used for this procedure. More than is esesialy needed, but it is easier this way.

